

32

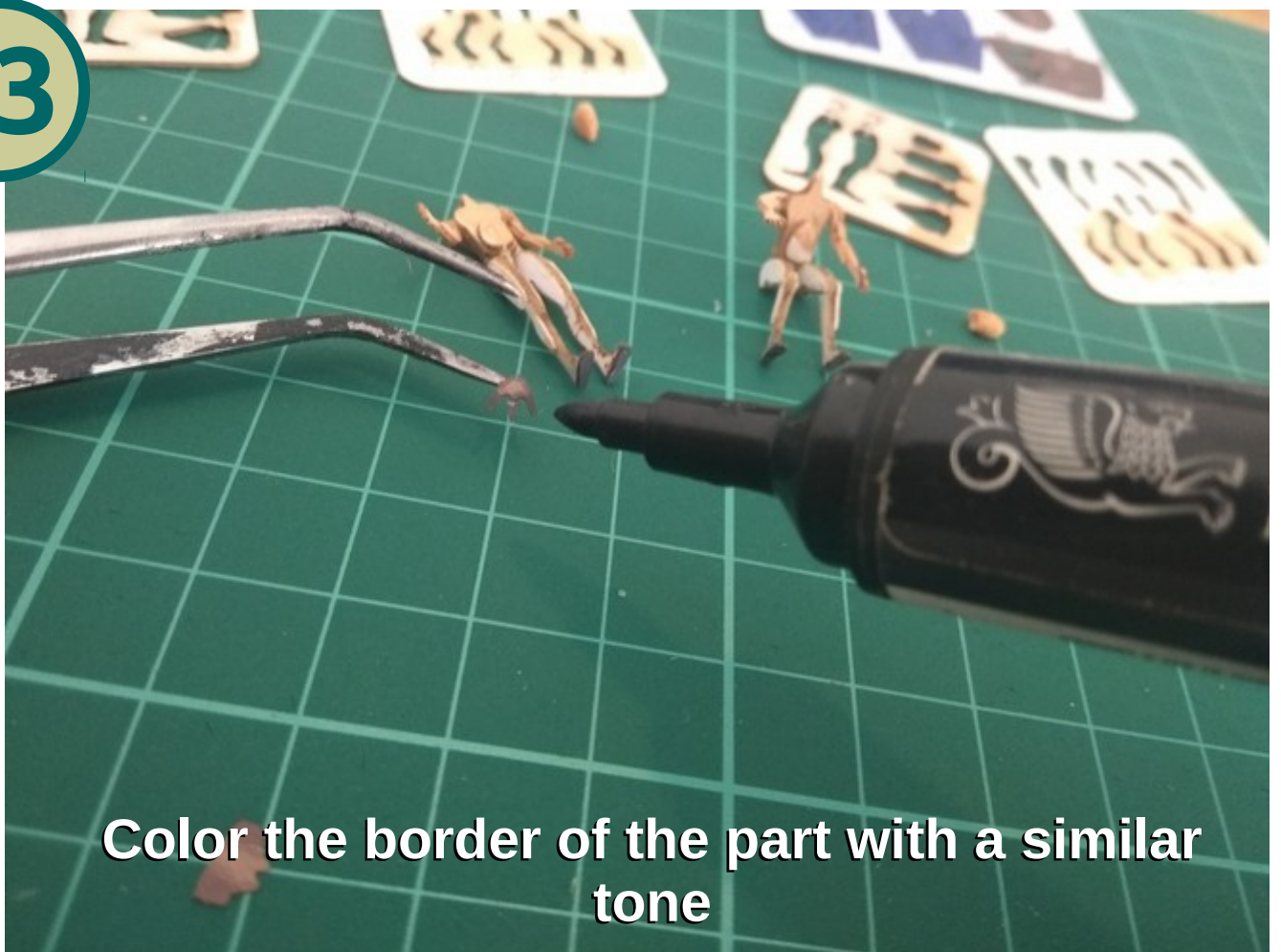

Lets start with the boots, use the red dots to cut the pat out

33



Color the border of the part with a similar tone

34

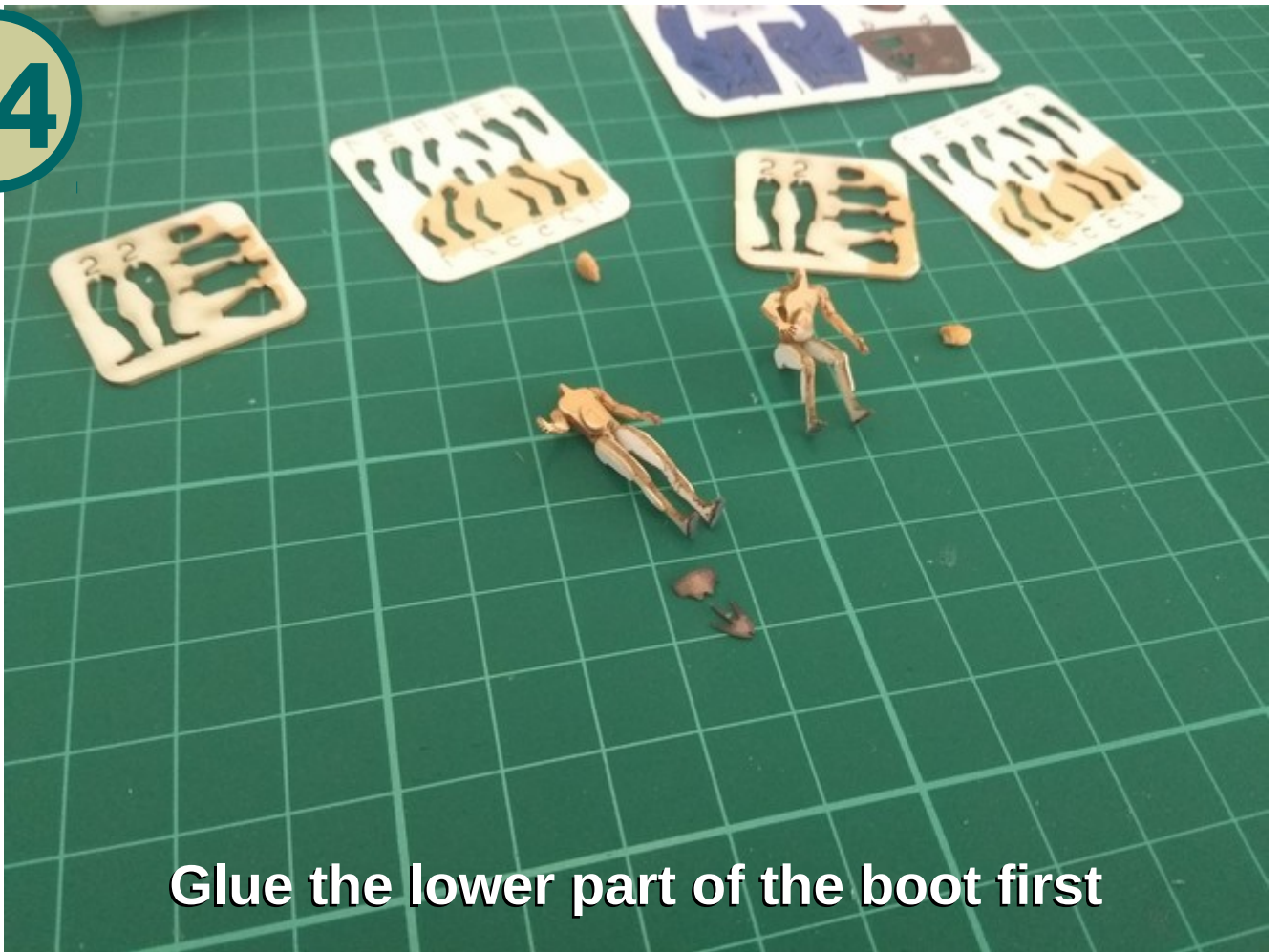

Glue the lower part of the boot first

35



Gently press the part around the foot

36



Glue the other part of the boot from the rear part of the leg and fold around

37



Repeat for the other leg and the other figure

38



Cut out the part e and f, those are going to be the sleeves

39



Glue the sleeve along the arm as shown in the picture

40



Let the glue dry and continue with the part
f

41



This is how it will look like

42



Glue around the arm

43



Repeat for the other figure

44



Another perspective of the figure

45



This is the result

46



Cut out the g part of the shirt

47

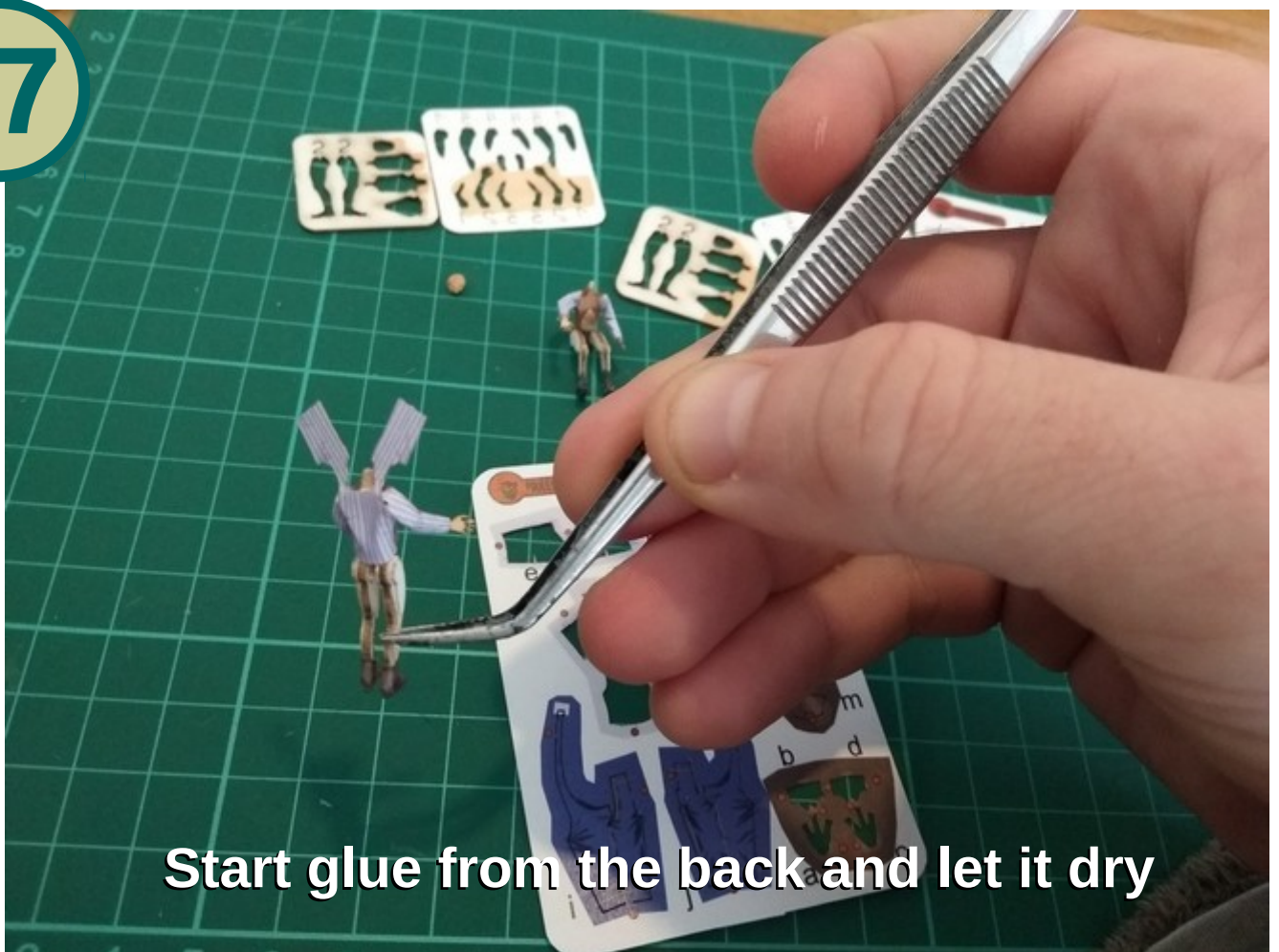

Start glue from the back and let it dry

48



It will look like this

49



Then fold and glue the front sides

50



Gently fold around to follow the body shape

51



Repeat for the other figure

52



Cut the h part for the neck

53

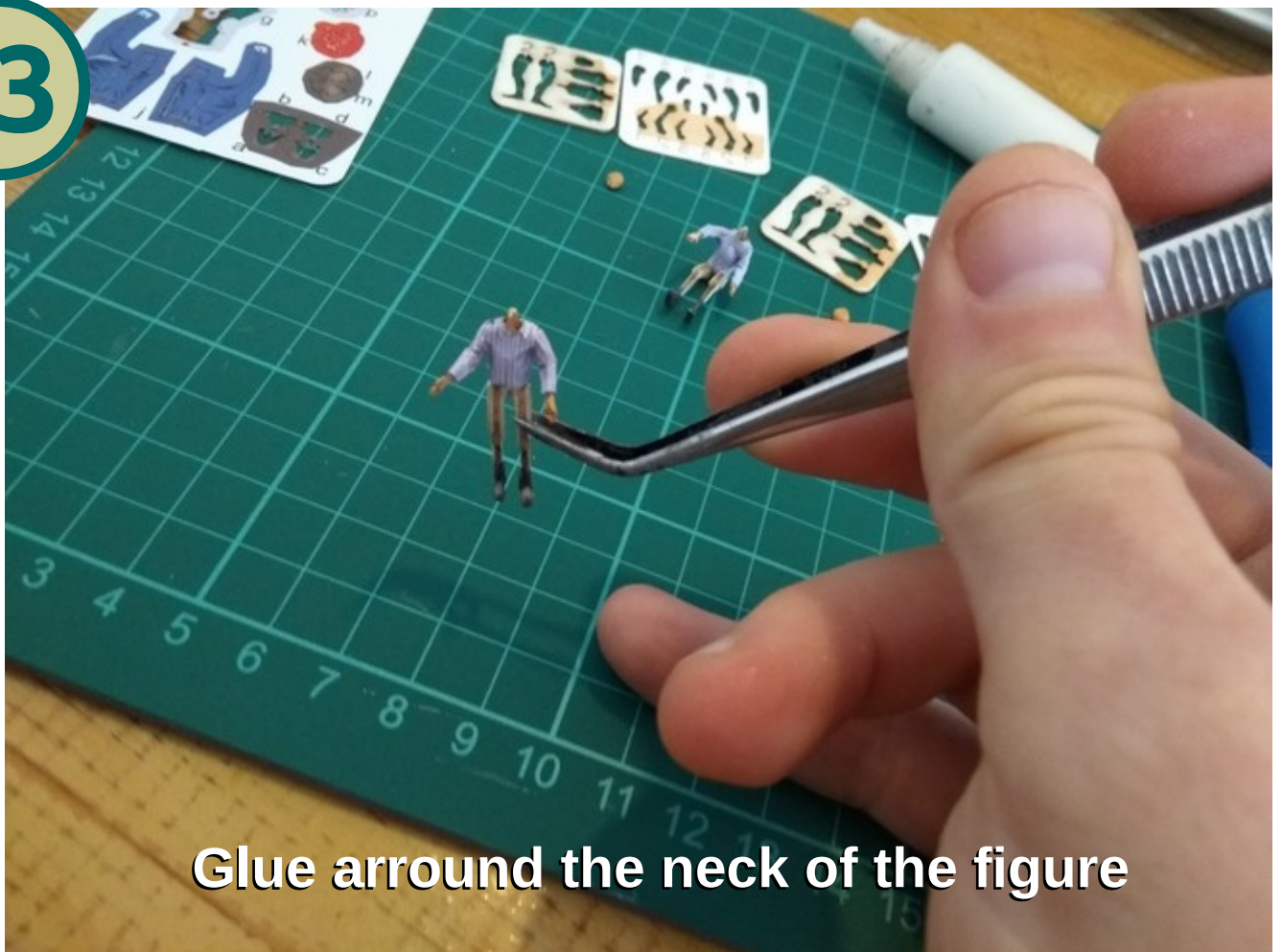

Glue around the neck of the figure

54



It is time for the pants, cut out the parts *i* and *j*

55

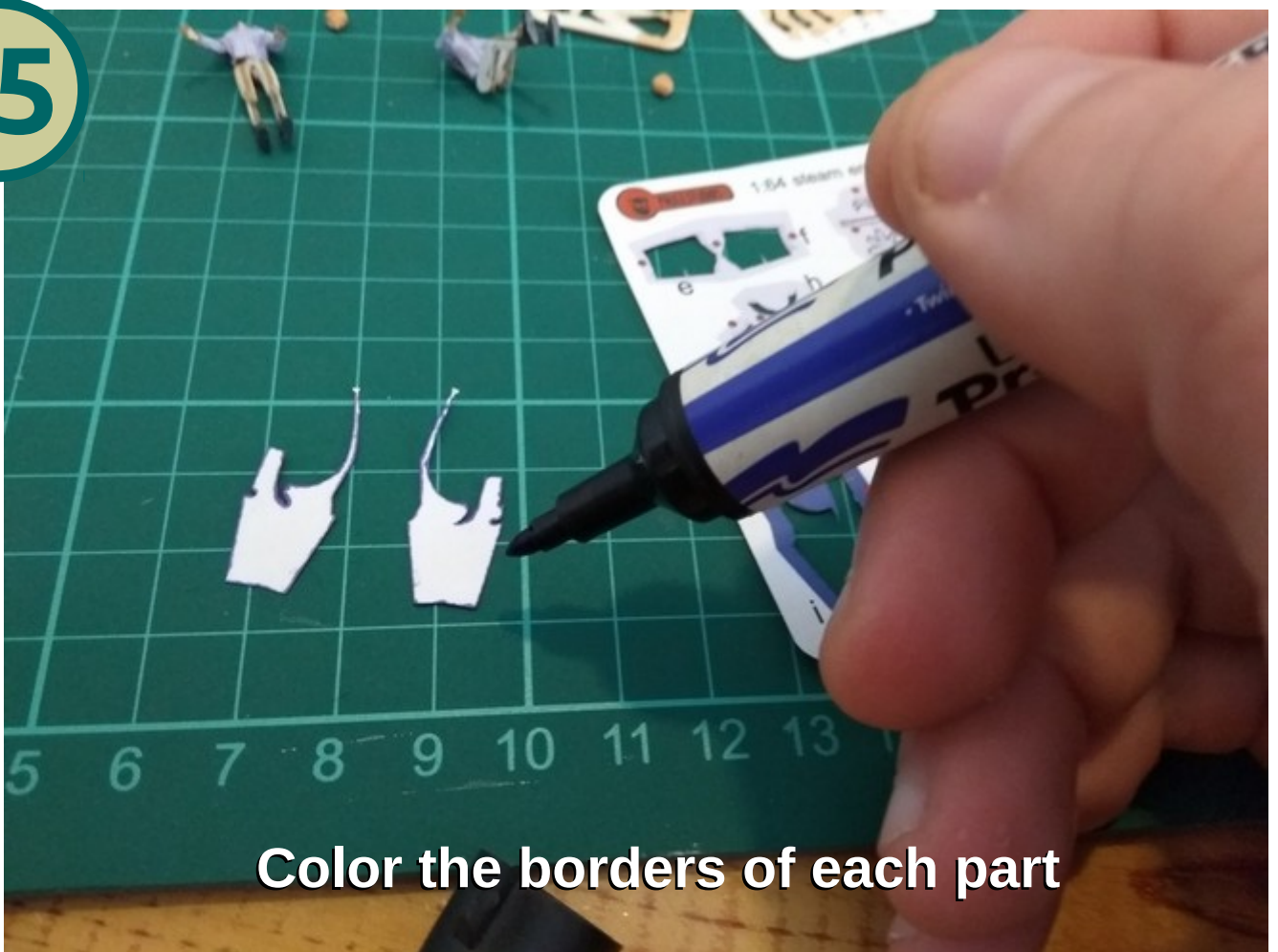

Color the borders of each part

56



Start from the rear part of the leg

57



Apply a gently press to ensure a gut
adhesion, let it dry

58



Repeat for the other part of the pants

59



Follow the natural shape of the legs

60



This is how it looks like from the front

61



Carefully fold around the leg to complete the pant side

62

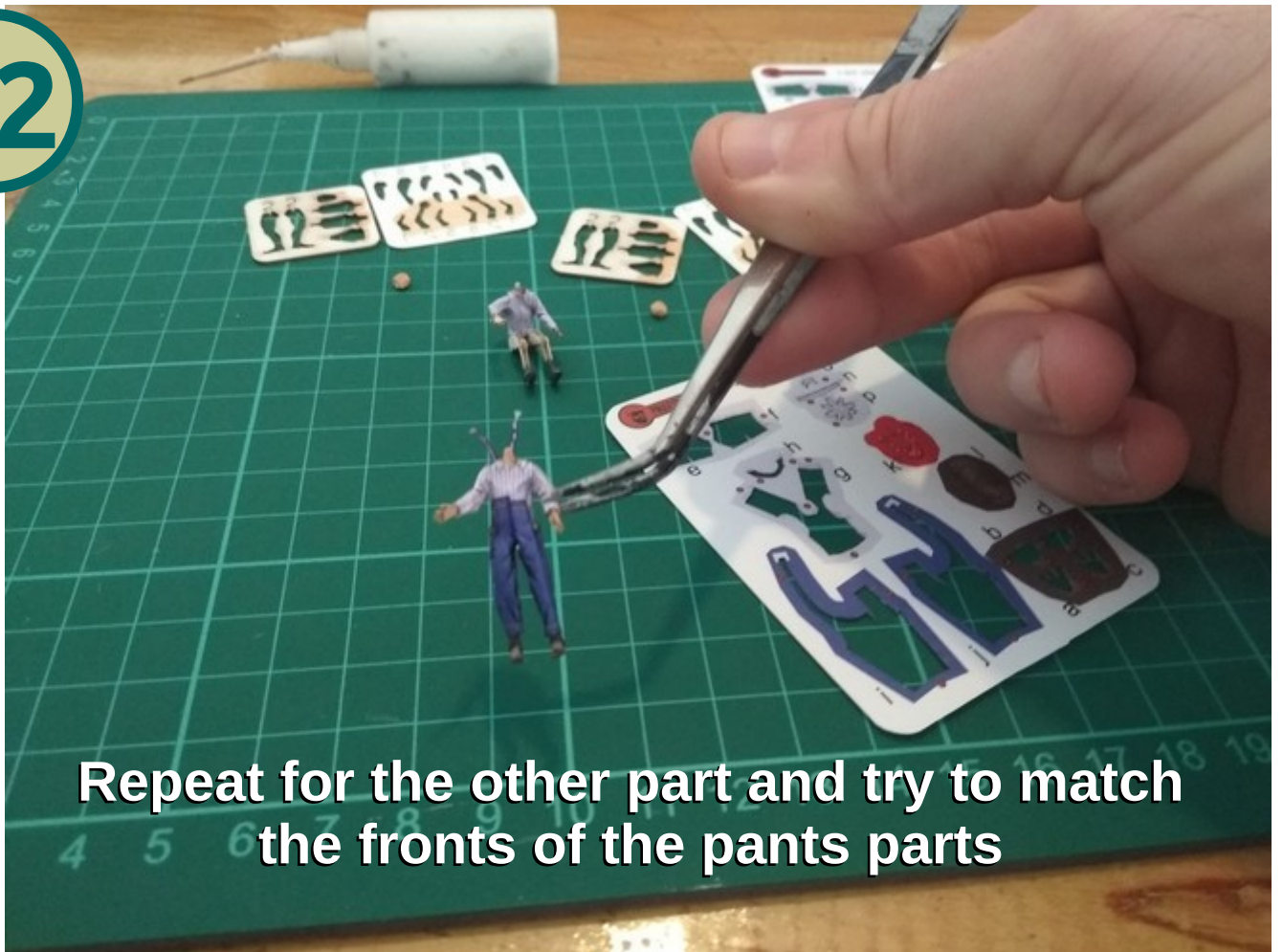

Repeat for the other part and try to match the fronts of the pants parts

63



Finish to glue the bib pants parts

64

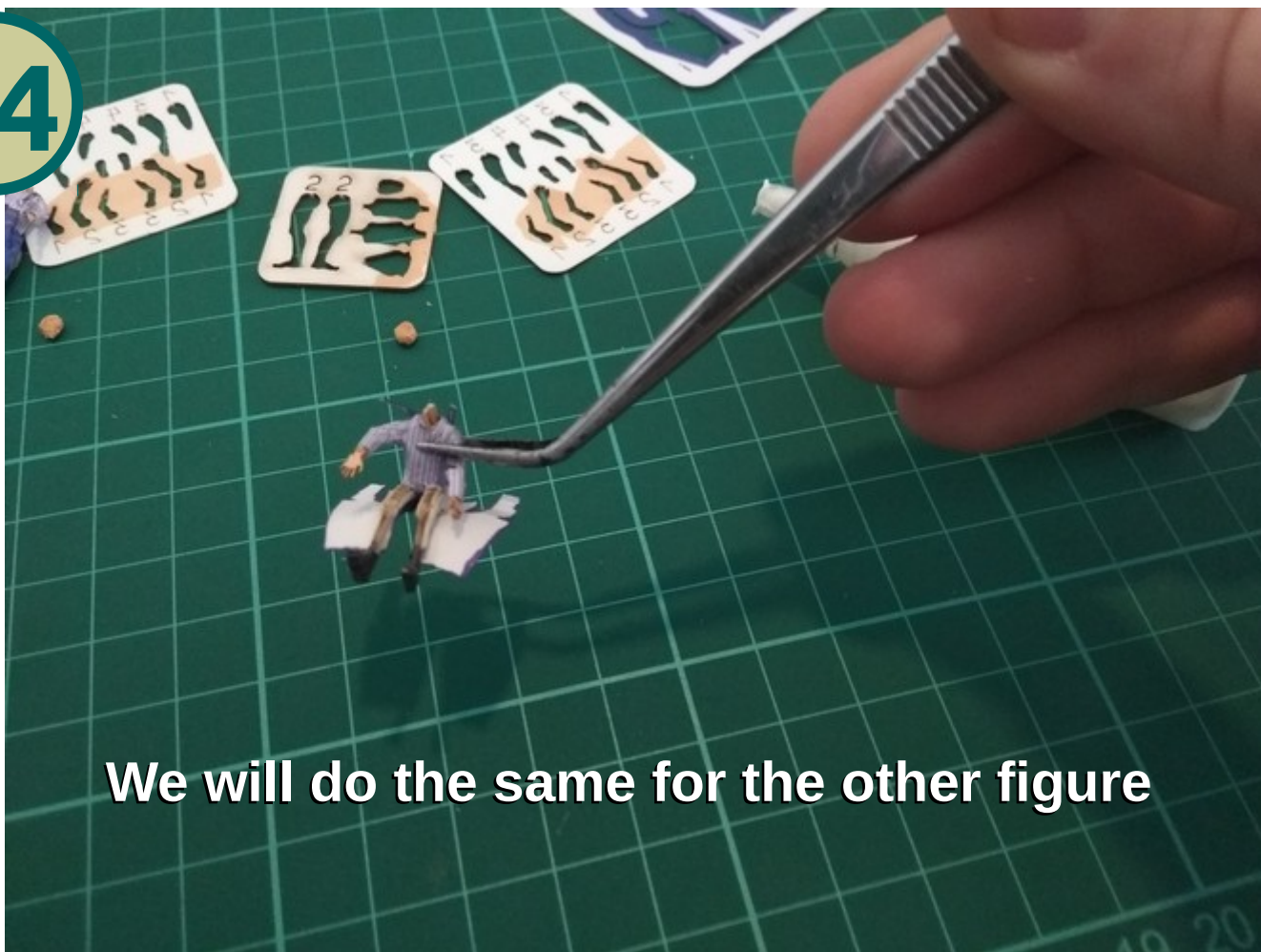

We will do the same for the other figure

65



Starting from the rear of the legs following the body shape

66



For sitting position it's a little bit tricky to fold the part around the leg, you can do some "cuts" to the part to ensure a good shaping

67



This is how it would look like

68



This is an optional part for the figure, but normally its a part of the engineer wear

69



Color borders before glue it

70



Glue the scarf around the neck

71



You can glue it with the knot in front or back side

74



Gloves are also an optional part, lets build one with gloves, for that we need to color the hands with a dark color

75

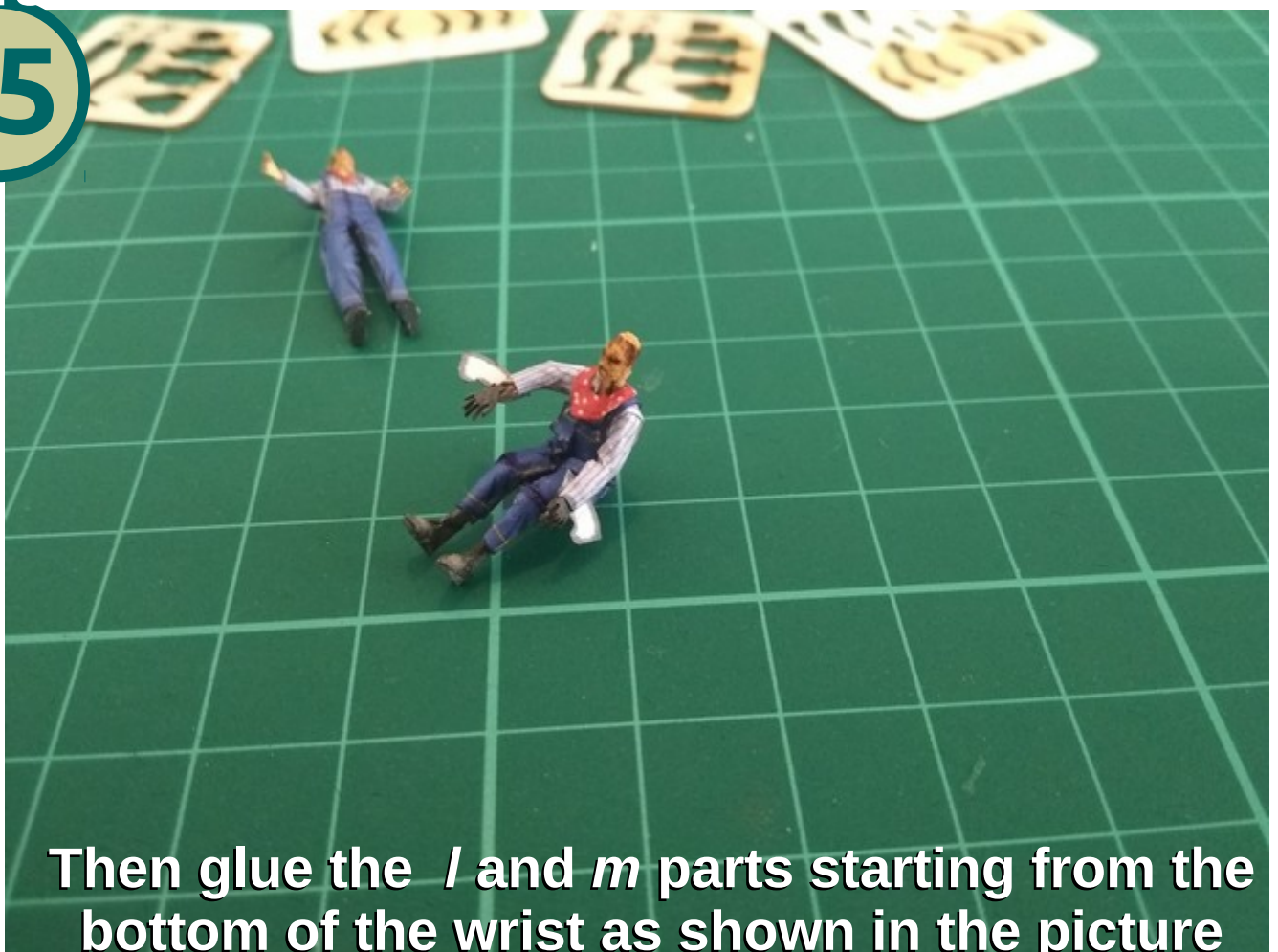

Then glue the *l* and *m* parts starting from the bottom of the wrist as shown in the picture

76



Fold the parts to finish the glove assembly

77



Lets cut out the part *n* for the hat

78

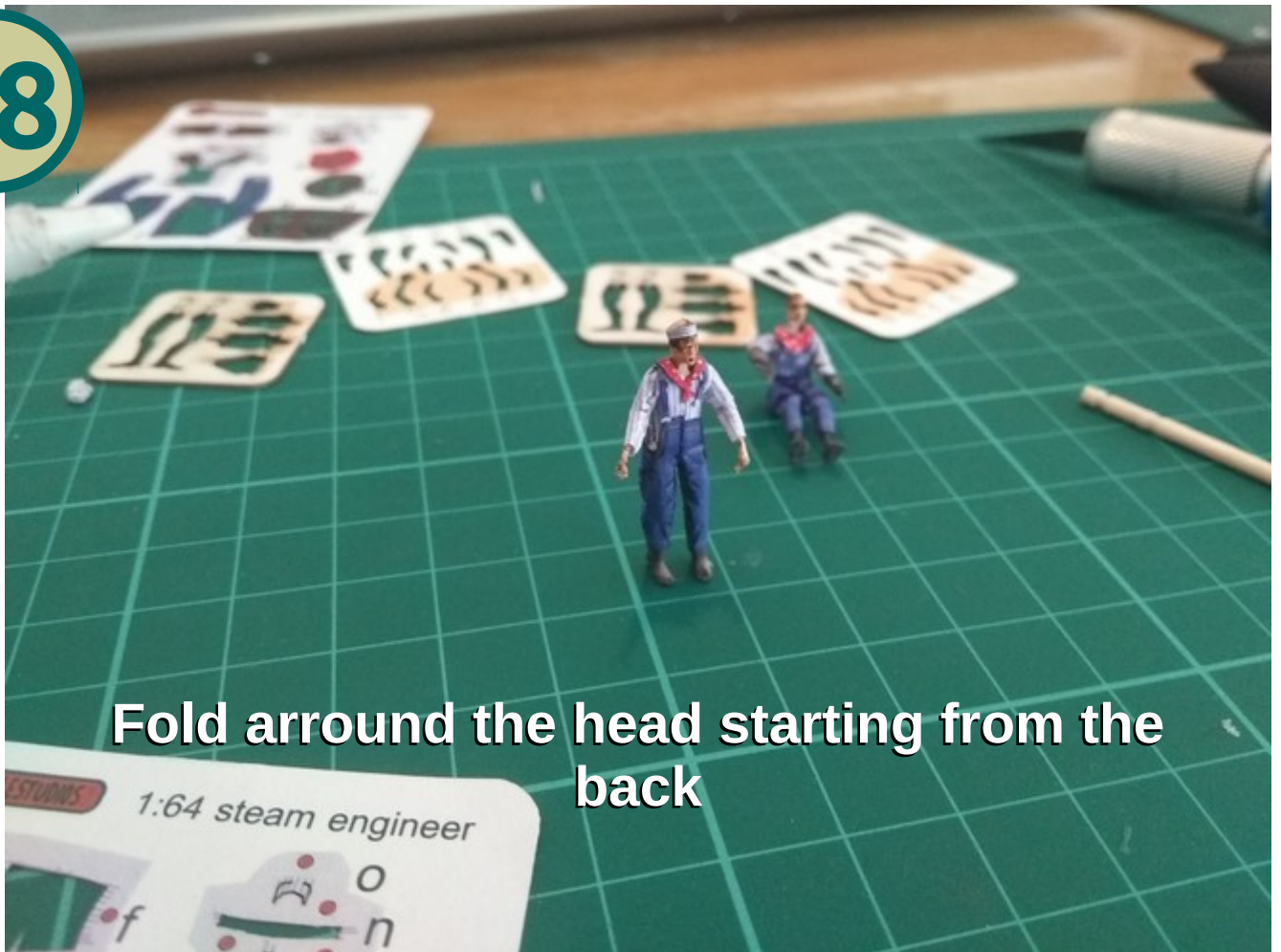

Fold around the head starting from the back

79

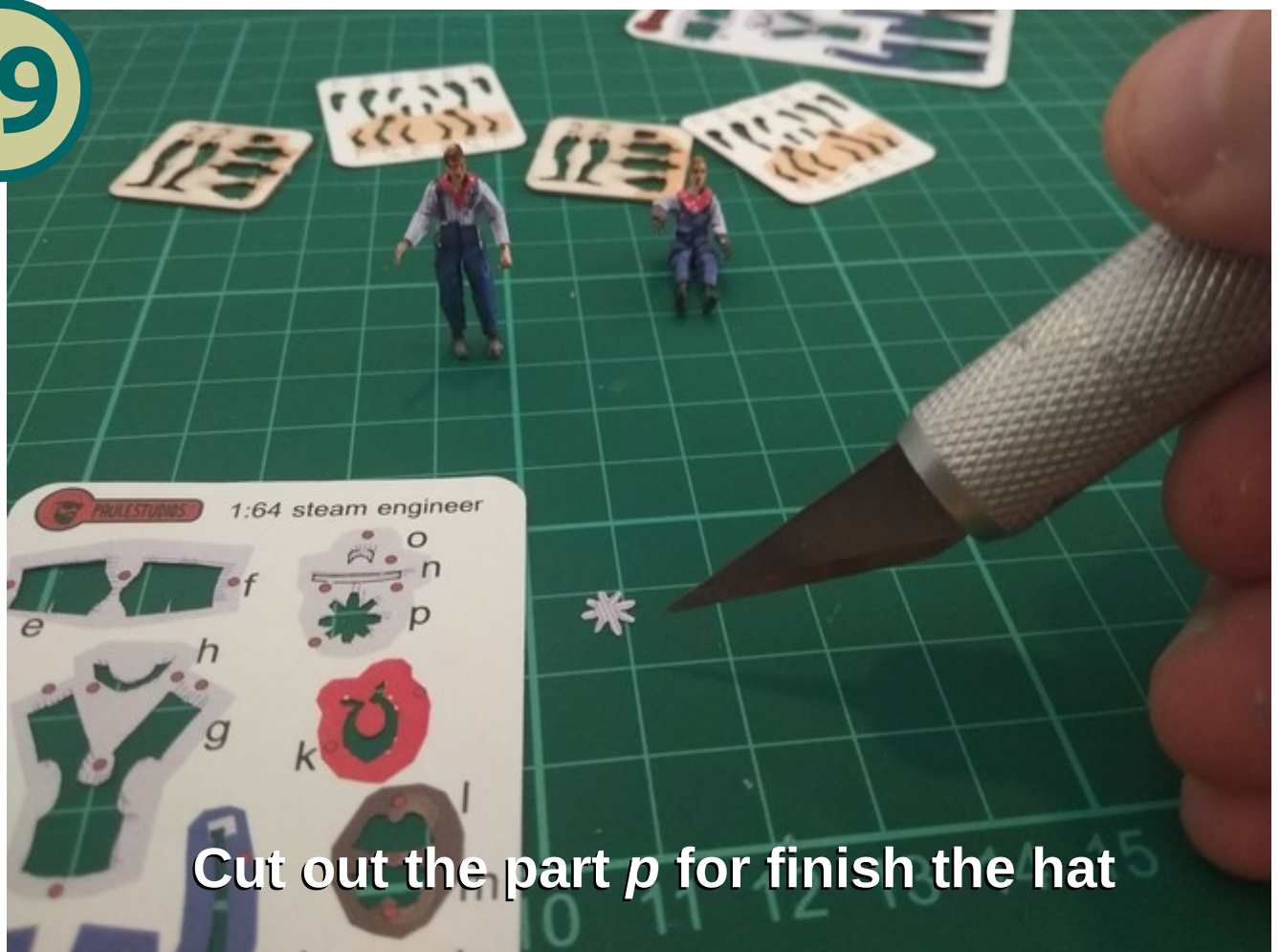

Cut out the part p for finish the hat

80

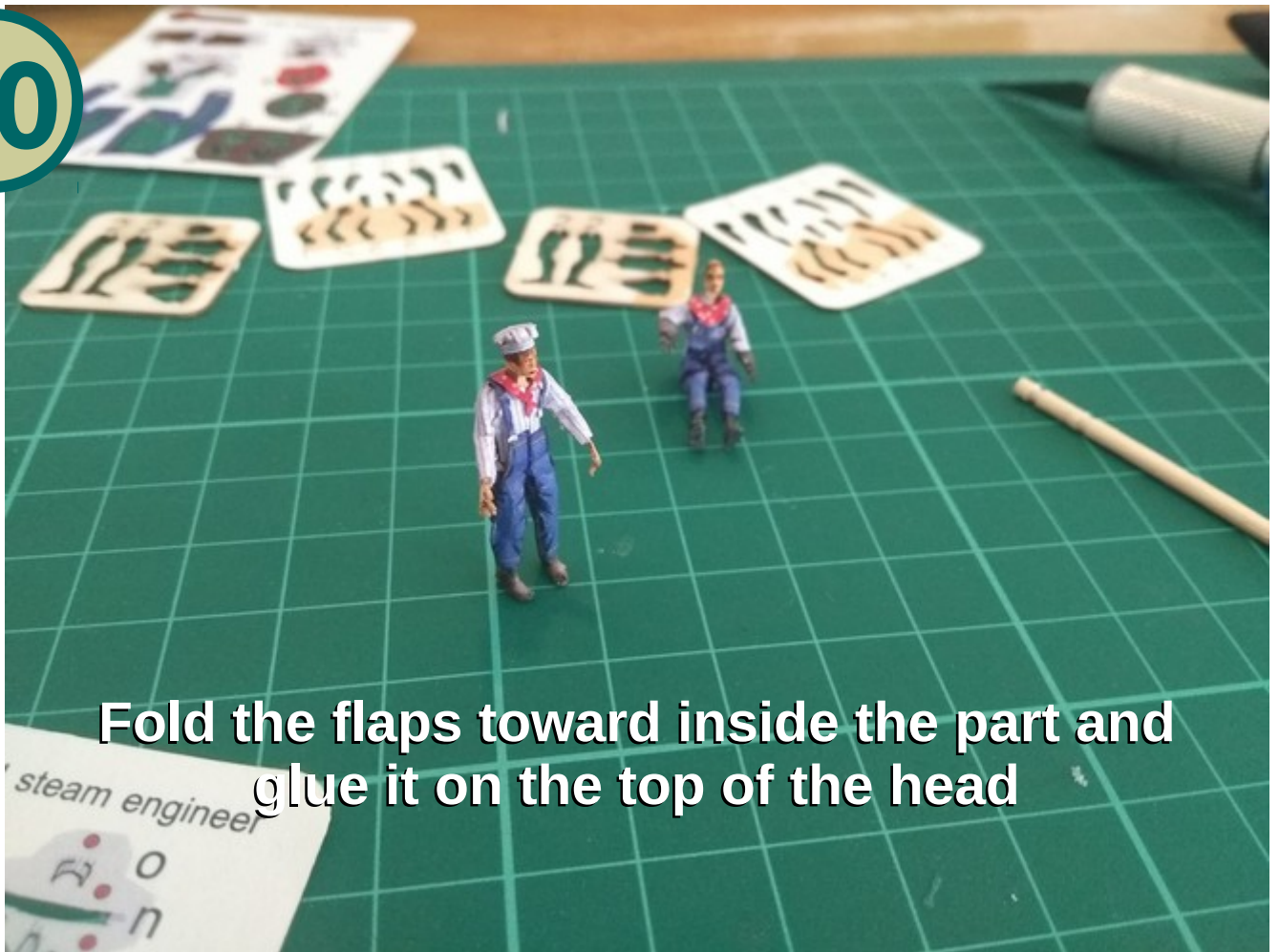

Fold the flaps toward inside the part and glue it on the top of the head

81



Finally glue the o part in front of the hat

82

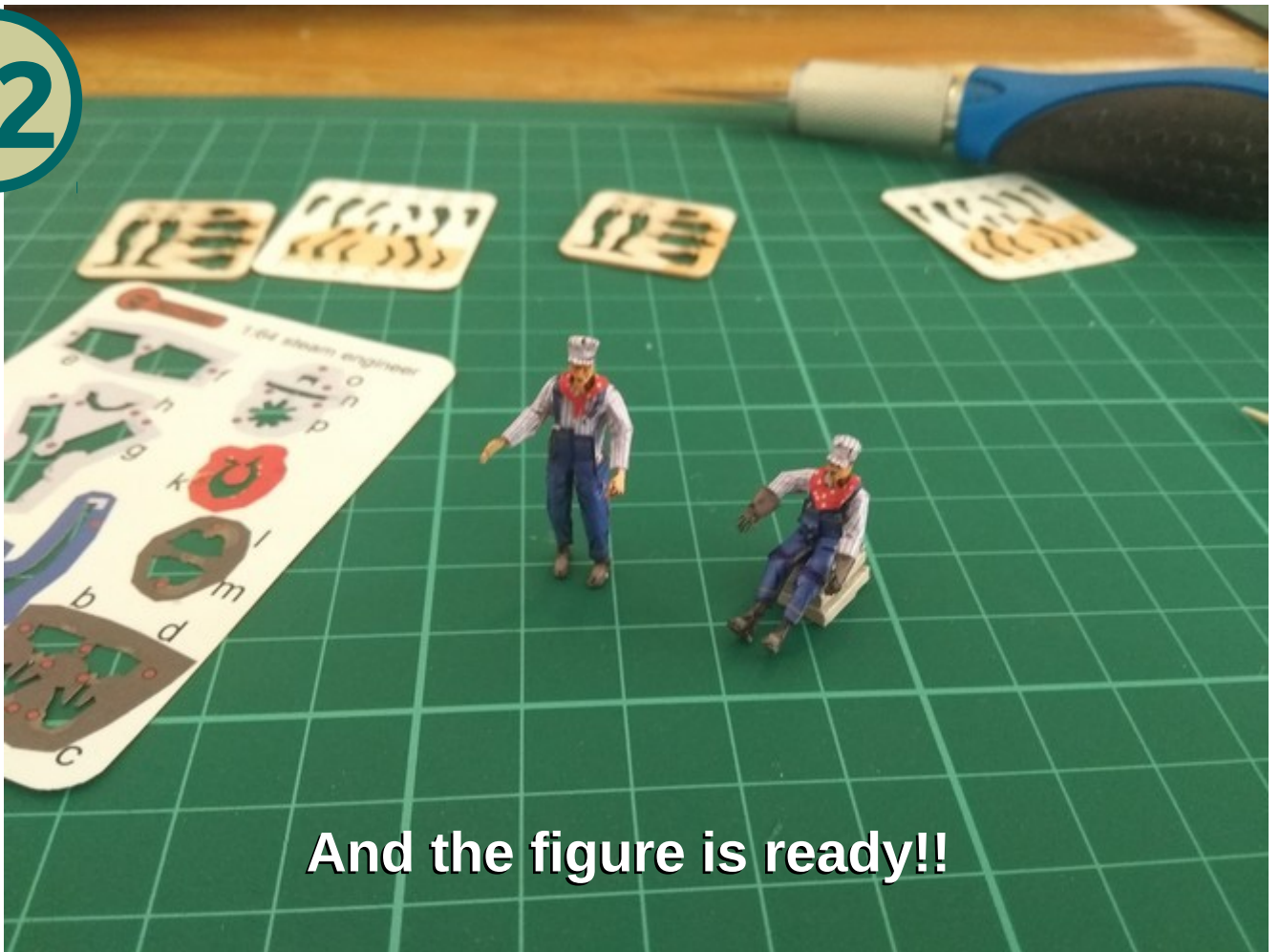

And the figure is ready!!

83

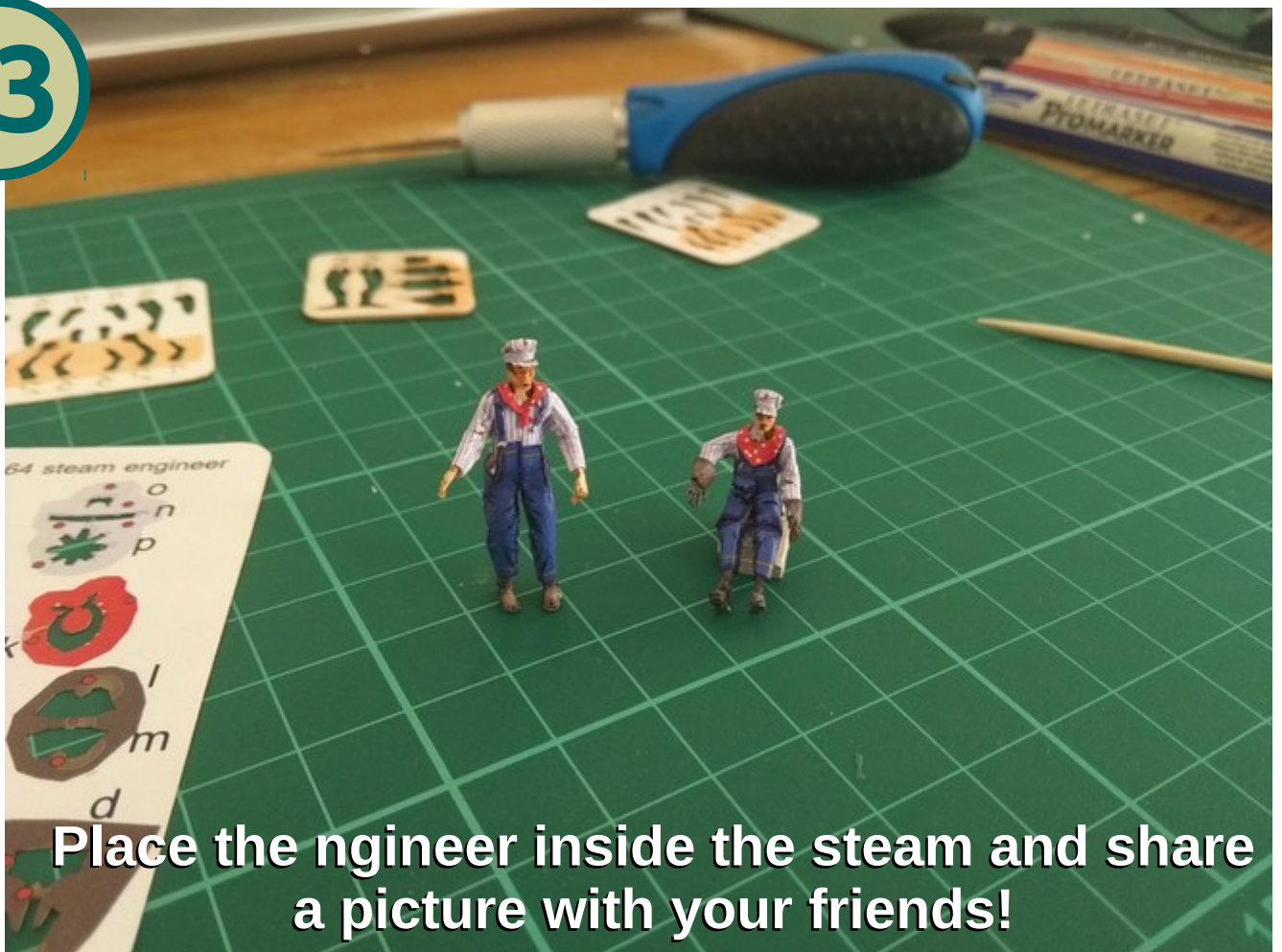

Place the engineer inside the steam and share a picture with your friends!